

Cement, Grout & Salt Residue Remover



Rapid action cleaning agent for removing cement residues, grout stains, salts, efflorescence and evening the appearance of discoloured grouts caused by over wetting. This product can be used in dilute or concentrated form, to assist removal of stubborn residues. It is manufactured using acid replacement technology, making it ideal for use on surfaces that would otherwise be acid sensitive such as limestone, sandstone, chrome and stainless steel. Ideal for use on porcelain pavers.

Coverage

	1 LTR	5 LTR	25 LTR
Mild cases	25 M ² /bottle	125 M ² /bottle	625 M ² /bottle
Severe cases	15 M ² /bottle	75 M ² /bottle	375 M ² /bottle
Extreme cases	5 M ² /bottle	25 M ² /bottle	125 M ² /bottle

Technical Features

- High performance
- Targets heavy or light films
- Walls & floors
- Rapid action
- Easy to use
- Acid replacement tech
- Interior & exterior
- Efflorescence remover



Directions for use

MECHANICAL APPLICATION: FLOORS



1 Dilute solution 1:1 with cool water and fill a light pressure sprayer.



2 Apply to the surface and leave for 5-10 minutes. Work in manageable areas at a time.



3 Scrub surfaces with a rotary scrubber to release cement & salt residues.



4 Extract the released residues. Repeat steps 2, 3 & 4 until surfaces are clean.



5 Rinse well with water. Allow surfaces to dry before allowing traffic or sealing.

MANUAL APPLICATION: FLOORS



1 Dilute solution 1:1 with cool water. Mask and protect areas not to be cleaned.

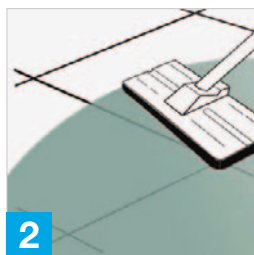

2 Apply to the surface working in manageable areas at a time.



3 Add a little water and gently scrub surfaces with a black pad to release the residues from the surface.



4 Sponge up and extract released residues. Repeat steps 2, 3 & 4 until surfaces are clean.

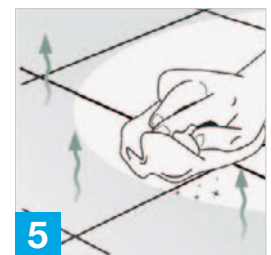

5 Rinse well with water. Allow surfaces to dry before allowing traffic or sealing.

Directions for use (Cont.)

MANUAL APPLICATION: WALLS



1 Dilute solution 1:1 with cool water and fill a light pressure sprayer.



2 Add a little water and gently scrub surfaces with a black pad to release residues from the surface.



3 Add a little water and gently scrub surfaces with a black pad to release residues from the surface.



4 Sponge to extract released residues from the surface. Repeat steps 2, 3 and 4 until the surface is clean.



5 Rinse well to finish. Allow to dry before sealing.

RESTORING PATCHY DISCOLOURED GROUT JOINTS FLOORS

INTENSIVE CLEANING TO EVEN THE APPEARANCE OF THE JOINTS

Modern cement based grouts can occasionally dry patchy for a number of reasons...separation of ingredients, slightly too wet a mix, slightly too dry a mix, not mixed well enough, not mixed in the correct proportions...etc. The following is an intensive cleaning guide to help restore patchy grout to a more even appearance.



1 Dilute solution 1:1 with cool water. Mask and protect areas not to be cleaned.

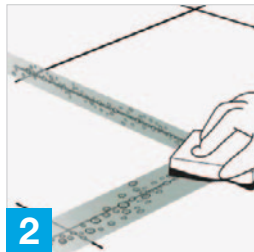

2 Apply to the surface working in manageable areas at a time.



3 Add a little water and gently scrub surfaces with a black pad to release the residues from the surface.



4 Sponge up and extract released residues. Repeat steps 2, 3 & 4 until surfaces are clean.



5 Rinse well with water. Allow surfaces to dry before allowing traffic or sealing.

MANUAL APPLICATION: WALLS



1 Dilute solution 1:1 in cool water.

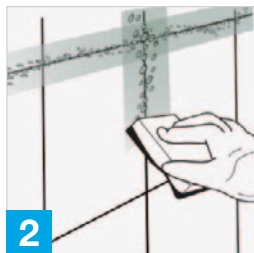

2 Apply to the surface of the grout joints using a sponge soaked in the solution.



3 Scrub immediately using a black emulsifying pad.



4 Rinse with cool water several times. Change rinsing water frequently.



5 Allow surfaces to dry naturally. On higher glazes buff with a dry cloth to finish.

FURTHER INFORMATION

USEFUL EQUIPMENT: Black emulsifying pad, rotary scrubbing machine with onboard water tank, stiff brush attachment for the machine, wet vac, buckets, sponges, absorbant towels (for spillage control), Plastic film and masking tape for covering and protecting any surfaces not to be cleaned.

Ensure that any sensitive surfaces not to be cleaned are properly covered and protected before beginning. Ensure that gloves and eye protection and suitable water proof clothing are worn at all times. After applying the cleaning solution to larger areas work in teams of two. One operator should agitate and scrub the

surface. The other operator should use a wet vac or sponge and water for immediate extraction. This will prevent released residues from re-absorbing into the surface and greatly reduce the drying time of surfaces. Use cool water only within the tank on the scrubbing machine. Do not put intensive cleaning solution through machine s as this will impair it's effectiveness. Steps or risers start on the top and work down. Try to work in manageable areas at a time and make sure to rinse well with plenty of water after each application. Rinsing should be repeated at least 2 times after cleaning. In areas where the staining is deep repeat the process until all of the stains have gone.